

SOLD



## 1211/6-8 Waterford Court, Bundall

Don't miss this opportunity to own in this quiet and convenient complex in Bundall. Situated between the Southport Golf Club and Gold Coast Turf Club, this spacious unit is perfect for investors and professional couples looking to purchase in the highly sought after Bundall pocket. Step into this spacious one bedroom plus study apartment, where the possibilities are endless. Boasting an Easterly aspect, the open plan living and dining area invites you to unwind in style. With a modern kitchen featuring sleek stone bench tops and contemporary appliances, the study, offering versatility as a potential second bedroom, adds a layer of adaptability to suit your lifestyle needs. Complete with a good-sized bathroom combined with laundry and split system air-conditioning throughout, comfort and convenience are seamlessly integrated into every corner of this stylish apartment....

...

1 1 1

**Price:** \$570,000

**View:** <https://remaxpropertycentre.com.au/8084843>

**Alex Wohler**

**M 0490 320 818**

RE/MAX Property Centre



# RE/MAX Property Centre

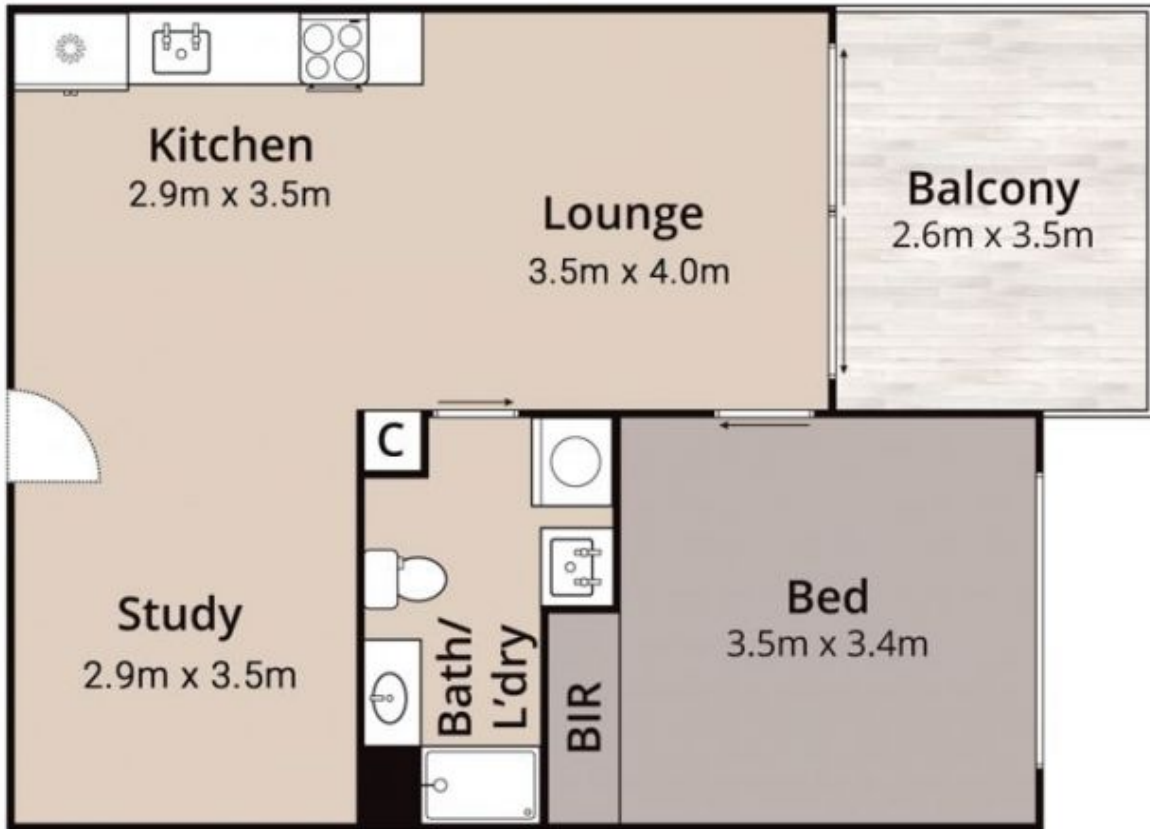

Approx Internal Area 53m<sup>2</sup>

While Media Abode has made every attempt to ensure the accuracy of the floor plan contained here, measurements are approximate and no responsibility is taken for any error, omission, or mis-statement. This plan is for illustrative purposes only.

1211/6-8 Waterford Court, Bundall