

SOLD



2902/89 Surf Parade, Broadbeach

Sold before the auction by Rima Stafford and Chloe Hemsworth.

The Wave building is renowned for its location, high quality build, large sized apartments, quality finishes and award-winning design. Two levels of facilities with the WOW factor rooftop boasting 360-degree views, spanning from Brisbane, hinterland mountains and to Coolangatta. Please be sure to click on the video tab. Send an email enquiry for a fact sheet and letter of offer.

Fast facts:

- Serious sellers will look at offers prior to auction
- Auction held at Remax office (not on site)...

...

2 2 1

Price: \$1,500,000

View: <https://remaxpropertycentre.com.au/7892650>

Rima Stafford
M 0400 707 745



Chloe Hemsworth
0451947499



RE/MAX Property Centre

2902/89 Surf Parade, Broadbeach

2 2 1 + MPR

internal 118 m² | external 31 m² | parking + storage 35 m² | total: 184 m²

RE/MAX Property Centre

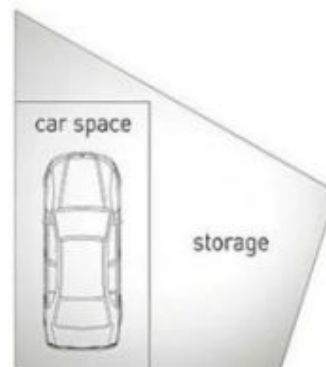
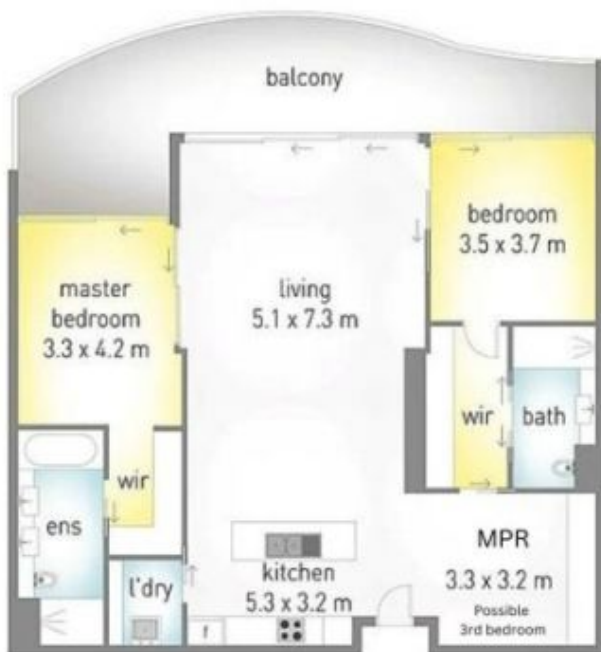

Dimensions are approximate. All information contained herein is gathered from sources we believe to be reliable. However we cannot guarantee its accuracy and interested persons should rely on their own enquiries.