

SOLD



16 Chuter Avenue, Southport

SOLD BY ALEX WOHLER UNDER THE HAMMER

Don't miss out on the chance to make this lovely home your own. This single level home in Chirn Park is the perfect choice for families looking for a spacious and well-presented property backing onto parkland.

Boasting spacious living throughout with 2 living areas, three good sized bedrooms, large kitchen with ample storage and a covered entertaining patio with rear access to parkland.

Additionally, the home is conveniently located close to the heart of Chirn Park where you can find excellent cafes and restaurants, a short distance to Griffith University and the Hospital, G-Link light rail station, Musgrave Bowls Club, Queen's Cricket Club, the Broadwater and Musgrave Park where dogs can run free for hours. ...

...

3  2  2 

Price: \$855,000

View: <https://remaxpropertycentre.com.au/7656163>

Alex Wohler

M 0490 320 818



Kohl Van Bennekom

0493 530 160



RE/MAX Property Centre

Shop 6/110 Monaco Street

07 5629 7735



Ground Floor

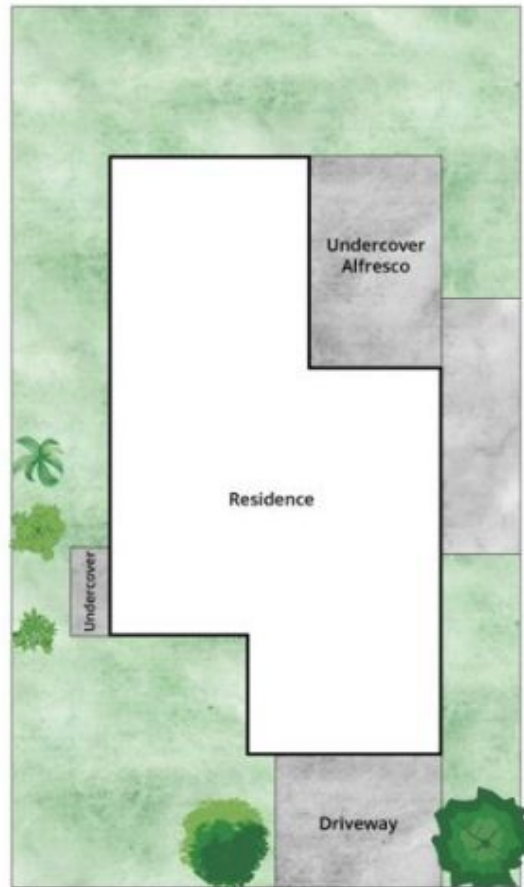

Site Plan

Approx Internal Area 163m²
 Approx Land Size Area 539m²

Whilst Media Abode has made every attempt to ensure the accuracy of the floor plan contained here, measurements are approximate and no responsibility is taken for any error, omission, or mis-statement. This plan is for illustrative purposes only.



16 Chuter Avenue, Southport