

SOLD



40/3 Marina Crescent, Hollywell

WOW! You had better be quick for this one. This highly sought after north facing two level home in 'Port Meirion' offers breathtaking Broadwater views. Conveniently located just a short stroll to the many restaurants, cafes and shops at the Runaway Bay Marina and only a short drive to The Paradise Point dining precinct and Runaway Bay Shopping Centre. Sit back and enjoy the many features this home has to offer -

- * Spacious open plan living and dining area capturing magnificent Broadwater views.
- * First class new entertainer's kitchen with quality appliances.
- * Full length Bi fold doors opening onto the North facing, water view balcony....

...

4 2 2

Price: \$955,000
View: <https://remaxpropertycentre.com.au/6298810>

Danny Woolbank
M 0414 946 127



KB Seo
0431 142 818



RE/MAX Property Centre



Gold Coast Floor Plans
 0435 252505 Scale in Meters. Dimensions are approximate. Whilst every care has been made we cannot guarantee its 100% accuracy and interested persons should rely on their own enquiries

Onsite amenities:
 Swimming pool,
 heated spa, full size
 floodlit tennis court
 and two undercover
 BBQ areas

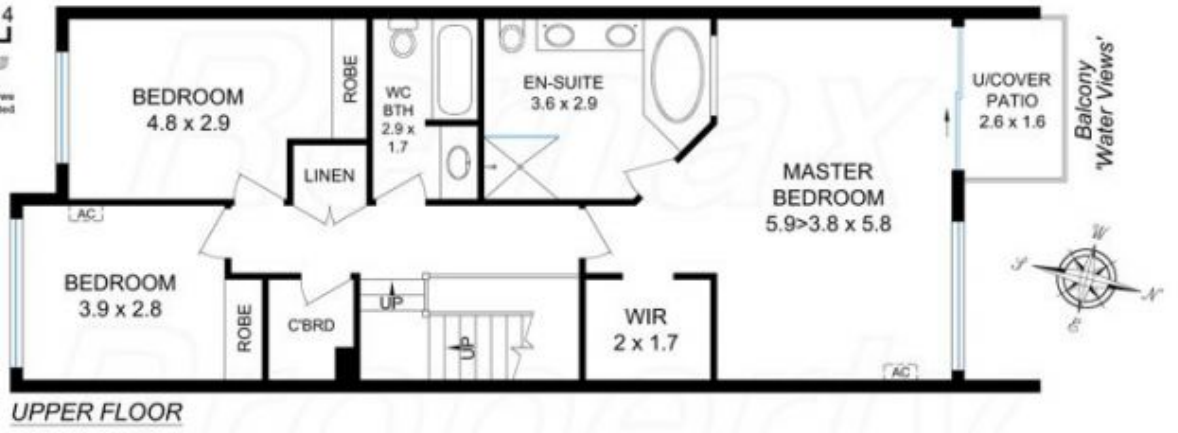

17.2m x 3.8m Marine berth
 Tandem Parking 9.6m x 2.9m / 28m²
 Patio Areas 21.8m²

'Port Meirion'
 40/3 MARINA CRESCENT, HOLLYWELL 4216

RE/MAX Property Centre

Int'l Gr Floor Area 89.6m²
 Int'l Upper Floor Area 84.6m²
 Combined 174.2m² or 18.8sq

Total Floor Area 224m² or 24.1sq