

SOLD



23 Berrigan Street, Southport

Located within a family orientated quiet precinct of Southport. Close to the beach, Southport Park Shopping Centre, Griffith University, TSS, Bellevue Park State School and the Gold Coast University Hospital.

This split level 3 bedroom home will appeal to families or the savvy investor. The property features split level living with 3 bedrooms upstairs, and the added bonus of a downstairs retreat.

UPSTAIRS FEATURES

- * 3 bedrooms all with built in robes.
- * 1 bathroom and separate toilet.
- * Renovated kitchen and bathroom....

...

3  2  2 

Price: \$524,000

View: <https://remaxpropertycentre.com.au/5286963>

Alex Wohler

M 0490 320 818

RE/MAX Property Centre





Gold Coast Floor Plans

Scale in Meters. Dimensions are approximate.
 Whilst every care has been made we cannot
 guarantee its 100% accuracy and interested
 persons should rely on their own enquiries



Energy Efficient
 Home with 1.5kw
 Solar system

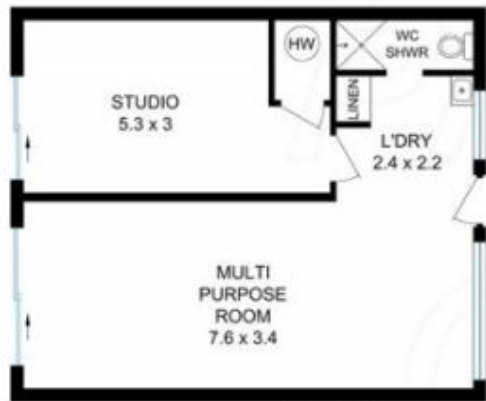

LOWER LEVEL

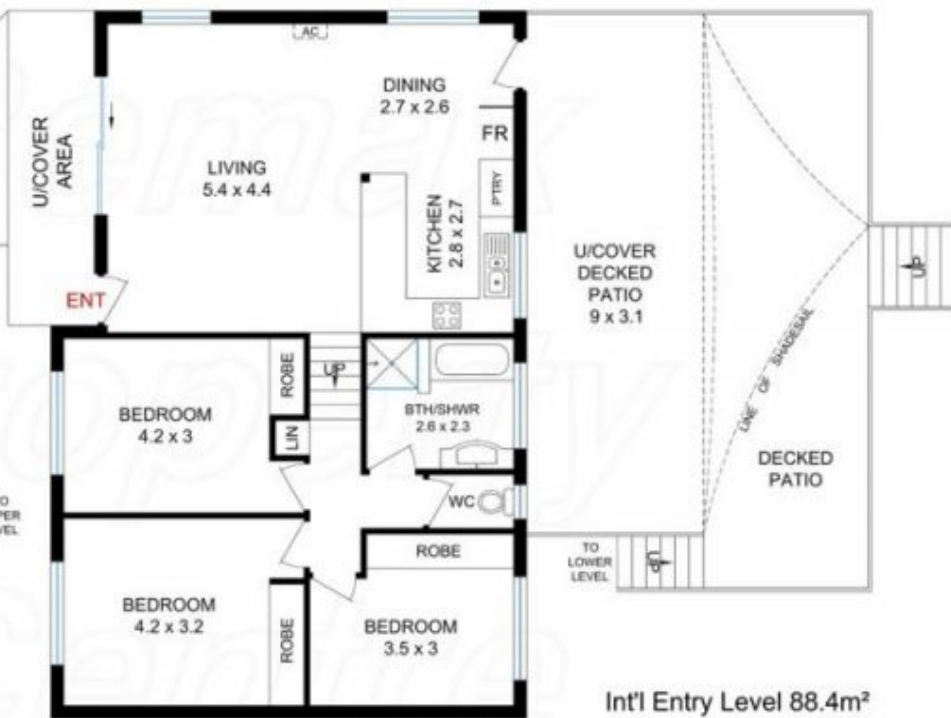

ENTRY LEVEL



Land Size 531m²
 Ceiling Height 2.4m - 2.1m

23 BERRIGAN STREET,
 SOUTHPORT 4215

RE/MAX Property Centre

Int'l Entry Level 88.4m²
 Int'l Lower Level 50m²
 Combined 138.4m² or 14.9sqs

Decked Patio Areas 72.5m²

Total Floor Area
210.9m² or 22.7sqs